

First Floor
558 sq.ft. (51.8 sq.m.) approx.

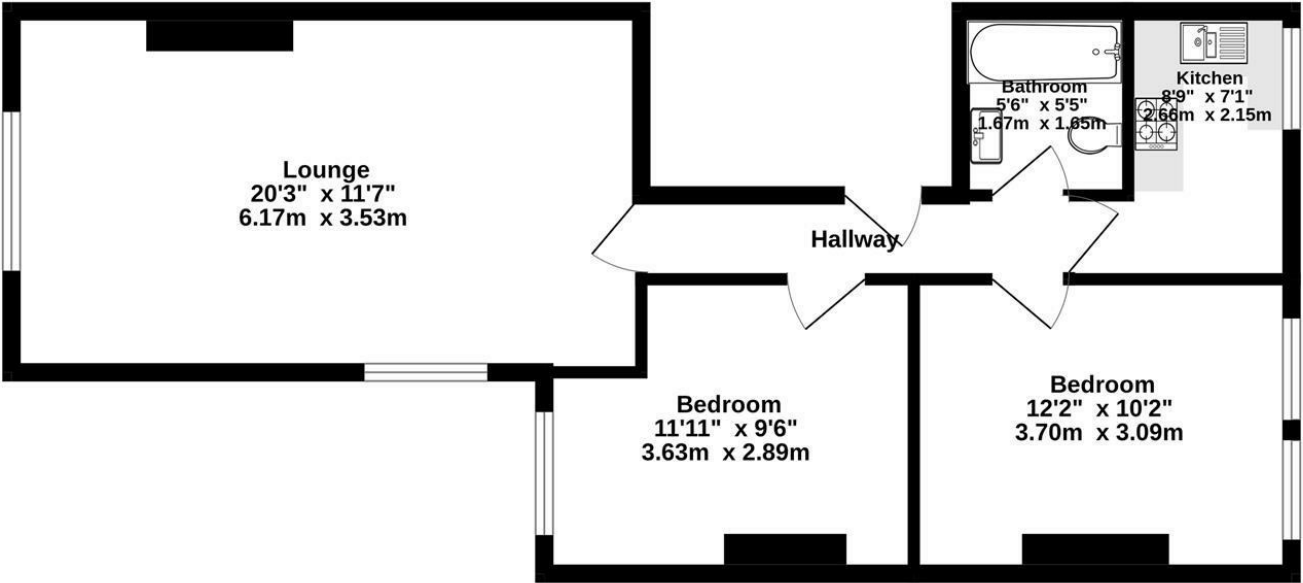

Cecile Park, N8
TOTAL FLOOR AREA : 558 sq.ft. (51.8 sq.m.) approx.
Whilst every attempt has been made to ensure the accuracy of the floorplan contained here, measurements of doors, windows, rooms and any other items are approximate and no responsibility is taken for any error, omission or mis-statement. This plan is for illustrative purposes only and should be used as such by any prospective purchaser. The services, systems and appliances shown have not been tested and no guarantee as to their operability or efficiency can be given.
Made with Metropix ©2025

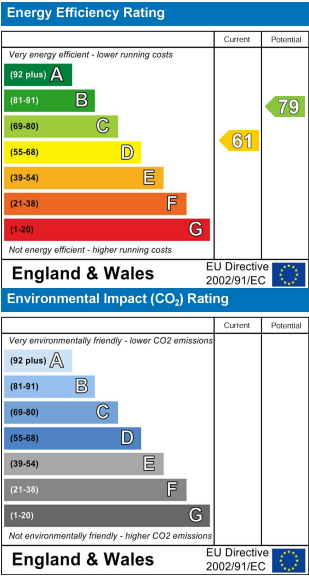
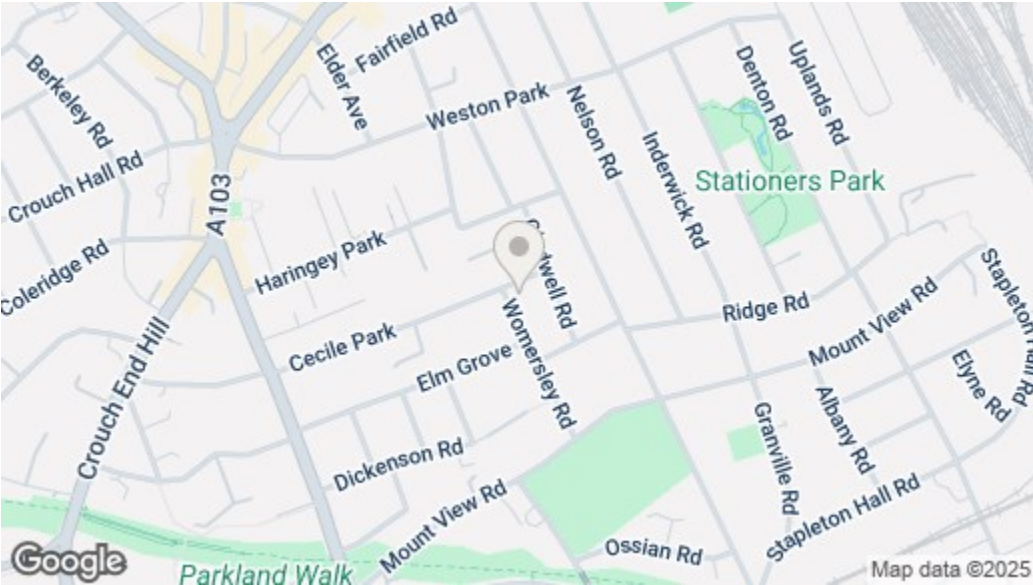

Cecile Park N8 9AR

£595,000 Leasehold

nextmove.com

Property Misdescriptions Act 1991
These particulars are thought to be materially correct though their accuracy is not guaranteed and they do not form part of any contract. All measurements are given only as a guide and services & appliances have not been tested. Purchasers are advised to appoint their own Surveyors & Conveyancers to satisfy themselves on all matters concerning any purchase.



- First Floor Conversion
- Generous Living Room
- Moments From The Broadway
- Two Bedroom Flat
- Sought-After Location
- Excellent Transport Links

Fabulous two bedroom apartment located on one of Crouch End's premier streets. Arranged on the first floor of an attractive semi-detached Victorian house, spacious accommodation comprises; two beautiful double bedrooms, a generous south-facing reception room, modern bathroom and a separate kitchen. All of the shops and eateries of The Broadway are close by, as are numerous good bus routes and trains from nearby Crouch Hill Station (Overground).

